

RERA NO: P02000004644
DTCP No.: L.P No. 58/2022/H



you belong here

FORGET THE STAYCATION, OWN THE
ultimate getaway!

Experience the joy of ownership with your own ultimate getaway! Escape the everyday hustle and indulge in a retreat that's always waiting for you.

Indraprastha
YADAGIRIGUTTA





Indraprastha

your
highway
to peace,
prosperity
and
profits

◀ HYDERABAD-WARANGAL HIGHWAY

Indraprastha

YADADRI TEMPLE



a gateway to
future growth!

YADAGIRIGUTTA

BLESSED ADVANTAGES

- CULTURAL HERITAGE
- FUTURE DEVELOPMENTS
- STRATEGIC LOCATION
- SEAMLESS CONNECTIVITY
- AFFORDABLE LAND RATES
- RAPID DEVELOPMENTS

01 MIN DRIVE
HYDERABAD-
WARANGAL HIGHWAY

10 MINS DRIVE
YADADRI TEMPLE

25 MINS DRIVE
AIIMS-BIBINAGAR

40 MINS DRIVE
GHATKESAR ORR EXIT

50 MINS DRIVE
UPPAL METRO STATION

Create Memories Today,
Build Wealth For Tomorrow



A weekend haven THAT GROWS WITH YOU!

This prime property offers a perfect blend of relaxation and investment potential, ensuring long-term value and memorable weekends.



SVS INDRAPRASTHA



rows of
elegant living



12 ACRES OF LAYOUT | 171 PLOTS | 165-371 SQUARE YARDS



1 BHK
VILLA
645 SQ FT

2 BHK
VILLA
832 SQ FT

your
weekend
home





a cozy retreat



Nature's
canvas
for family
tales

25+
amenities



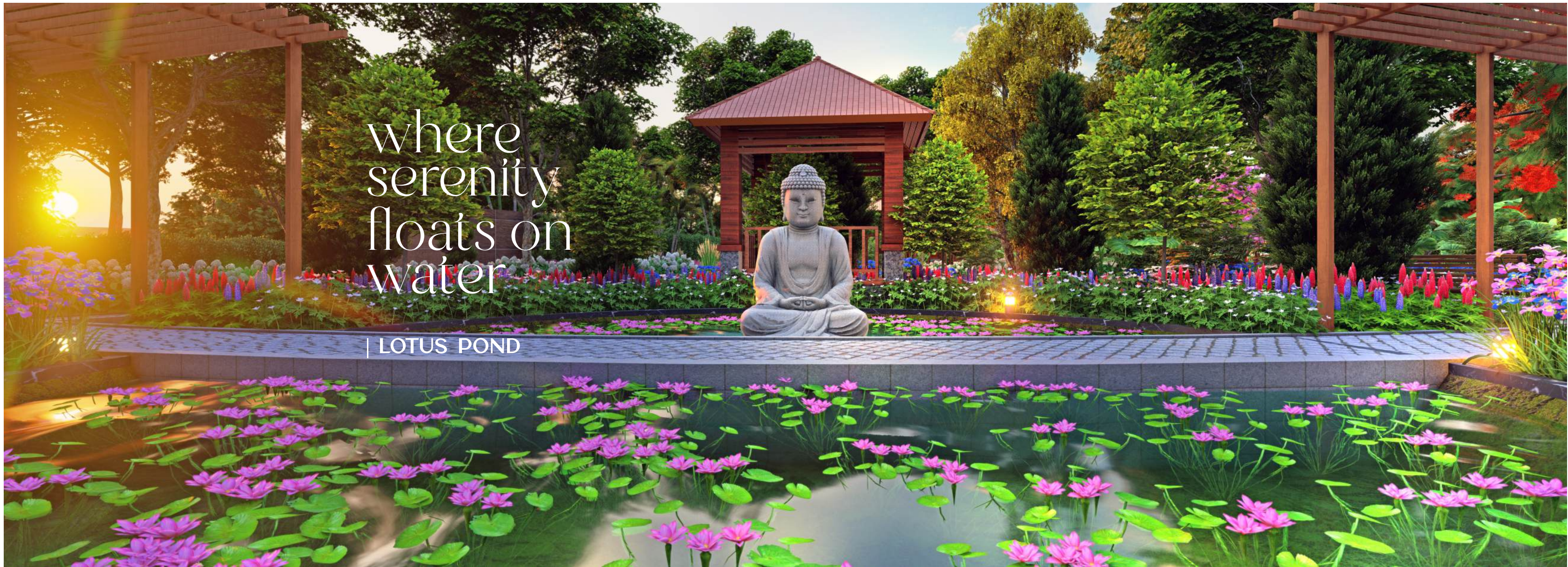

where
serenity
floats on
water

| LOTUS POND

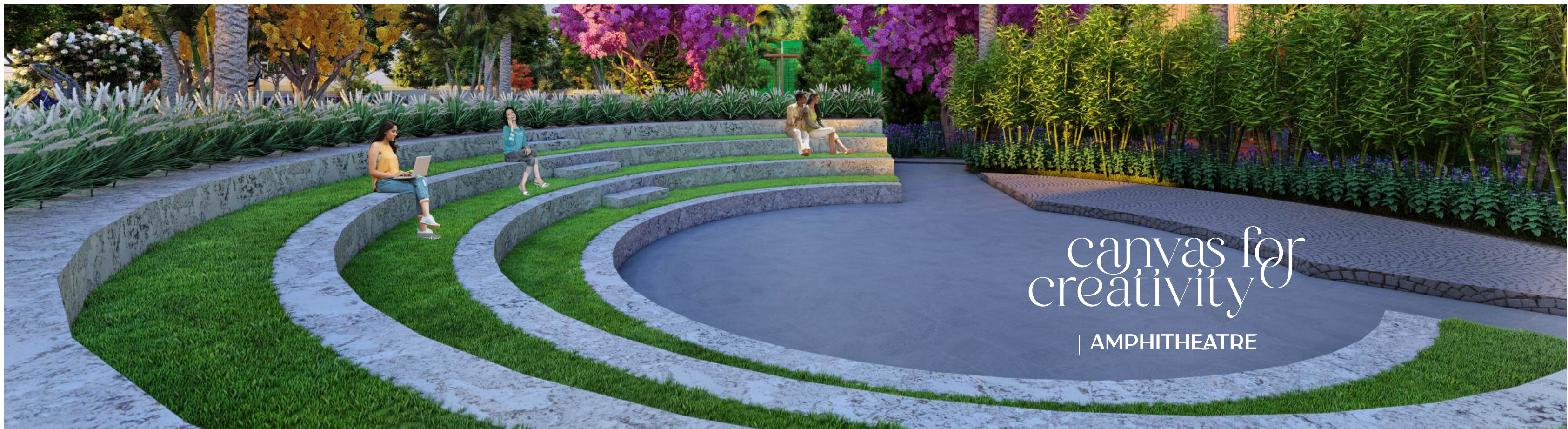

canvas for
creativity

| AMPHITHEATRE



breathe, move,
thrive

OUTDOOR GYM | SENIOR CITIZEN PARK | KIDS PLAY AREA

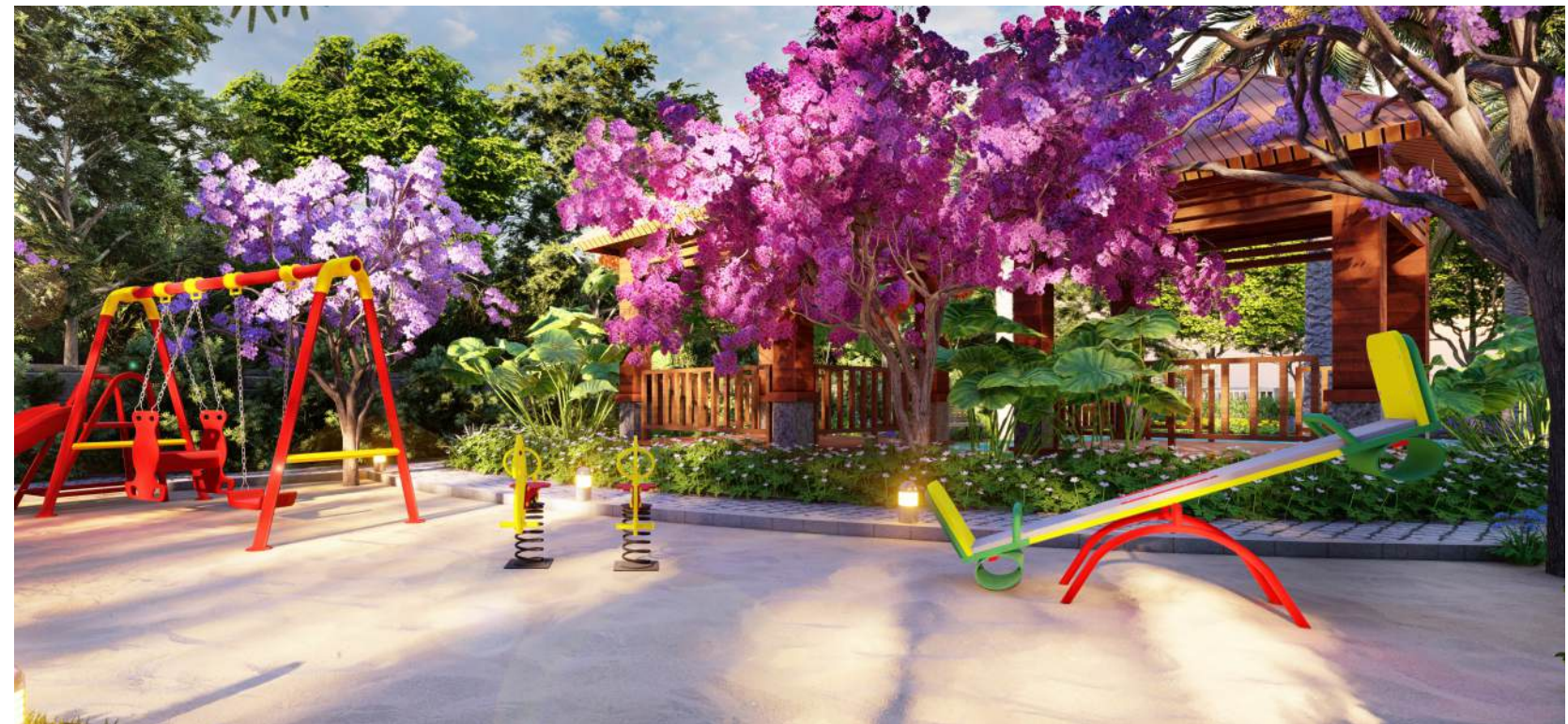



unwind by
the water

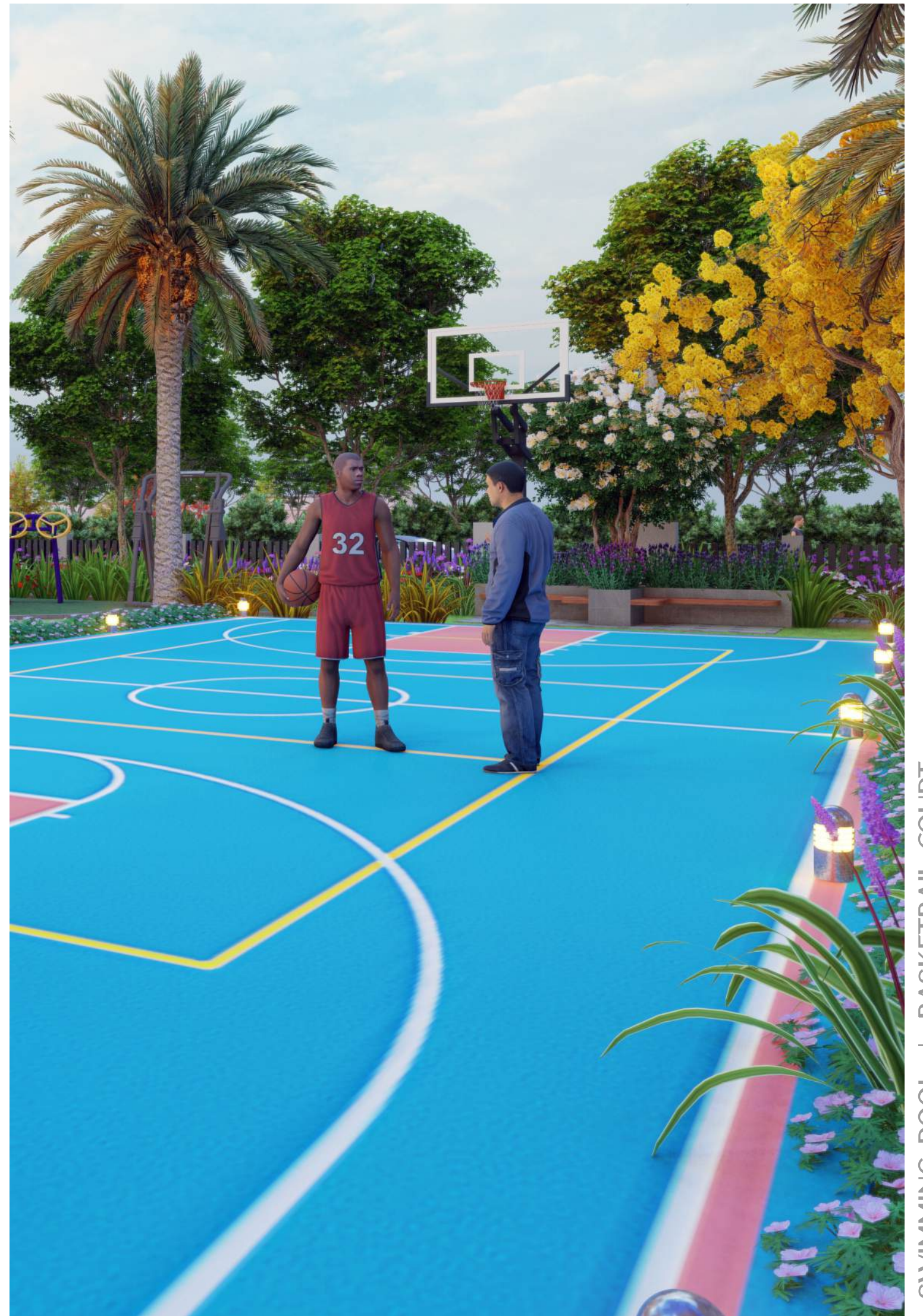

SWIMMING POOL | BASKETBALL COURT



ROOTS OF TRADITION,
branches
of joy

RACHABANDA TREE



amenities

POCKET 1

- AROMATIC GARDEN
- SPIRITUAL GARDEN
- HERBAL GARDEN
- YOGA LAWN
- LOTUS POND
- GAZEBO
- SENIOR CITIZEN PARK
- GRAND CELEBRATION LAWN
- SWIMMING POOL (ADULTS & KIDS)
- KIDS PLAY AREA
- BADMINTON COURT
- OUTDOOR GYM
- RACHABANDA TREE



amenities

POCKET 2

- TROPICAL GARDEN
- BUTTERFLY GARDEN
- KIDS PLAY AREA
- AMPHITHEATRE LAWN
- GAZEBO
- CRICKET PRACTICE NET
- BASKETBALL COURT
- VOLEYBALL COURT
- HERBAL GARDEN
- PET PARK
- AND MANY MORE

master layout plan

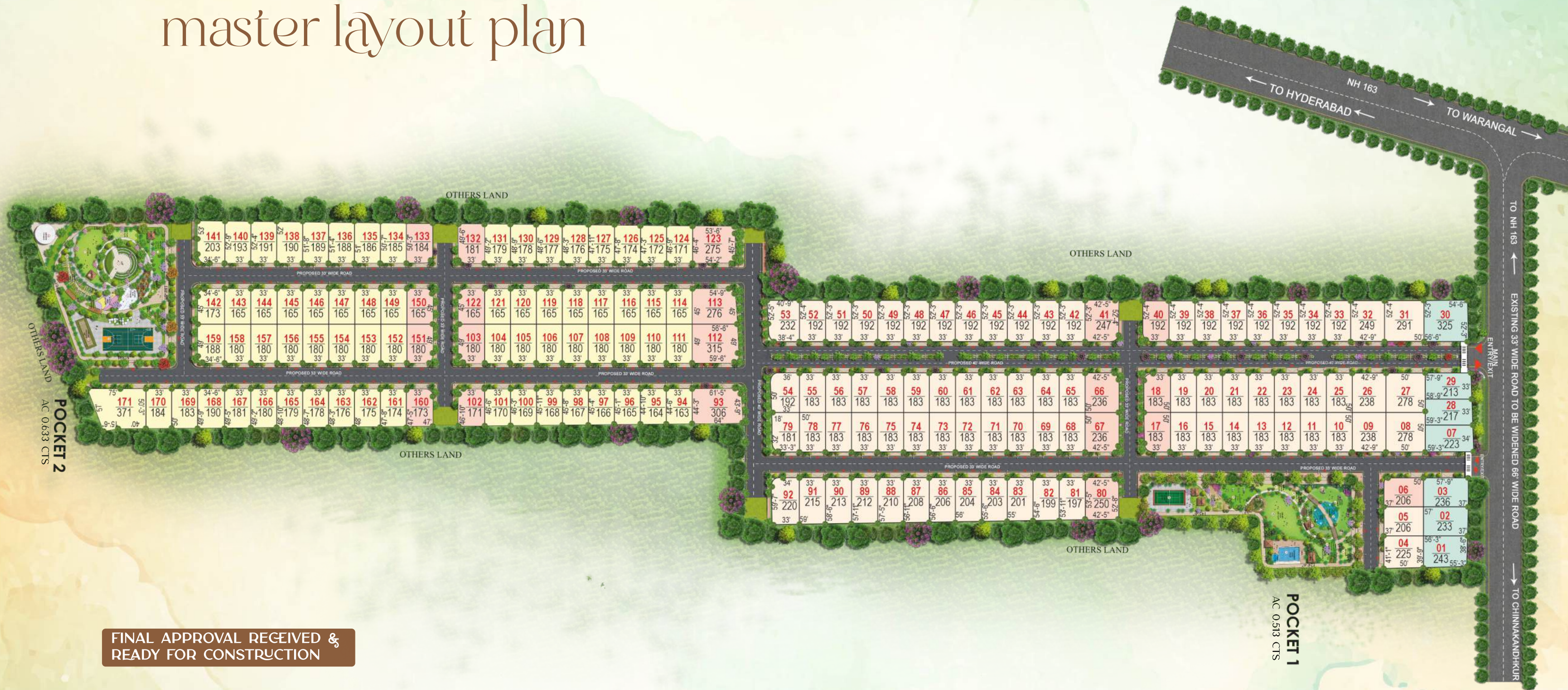

**FINAL APPROVAL RECEIVED &
READY FOR CONSTRUCTION**

AREA STATEMENT

TOTAL SITE AREA
TOTAL AREA: 11.60 ACRES (56,144 SQ YDS)
AREA BREAKDOWN
AREA LEFT FOR ROAD WIDENING:
SIZE: 0.14 ACRES (435.60 SQ YDS)
NET SITE AREA:
SIZE: 11.46 ACRES (55,466.40 SQ YDS)

PLOTTED AREA (59.39% OF NET SITE AREA):
SIZE: 6.806 ACRES (32,941.04 SQ YDS)
ROAD AREA (30.61% OF TOTAL SITE AREA):
SIZE: 3.508 ACRES (16,978.72 SQ YDS)
OPEN SPACES (10.00% OF TOTAL SITE AREA):
SIZE: 1.146 ACRES (5,546.64 SQ YDS)

PLOT TOPOLOGIES

- COMMERCIAL
- BLOCK A
- BLOCK B
- CORNER PLOTS



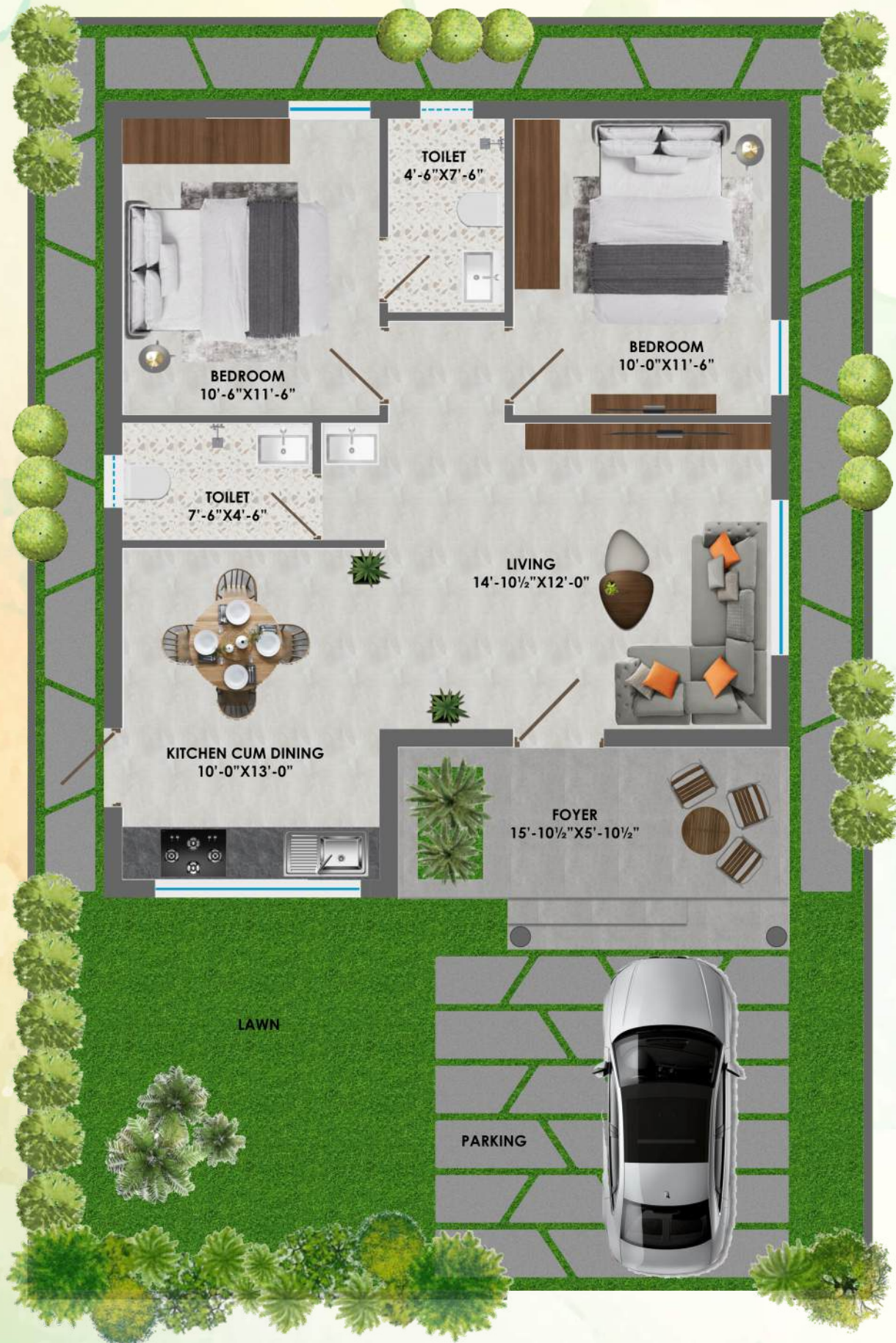

EAST FACING 2BHK VILLA

ENTRANCE

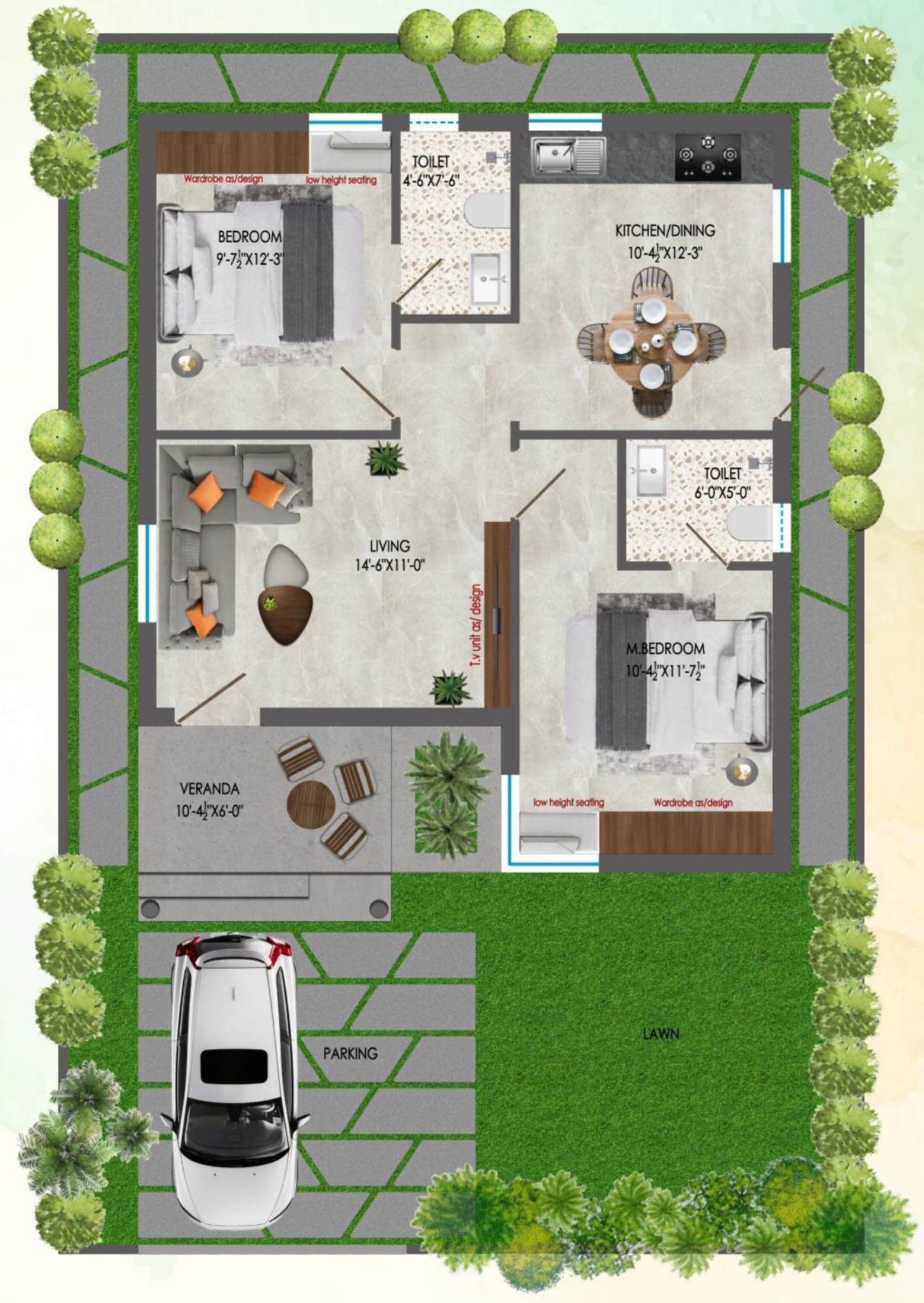

ENTRANCE

WEST FACING 2BHK VILLA

2 BHK VILLA

832 SQ FT



EAST FACING 1BHK VILLA

ENTRANCE

1 BHK VILLA | 645 SQ FT



ENTRANCE

WEST FACING 1BHK VILLA

1 BHK VILLA | 722 SQ FT

Location map



- 01 MIN DRIVE
HYDERABAD-
WARANGAL HIGHWAY
- 10 MINS DRIVE
YADADRI TEMPLE
- 25 MINS DRIVE
AIIMS-BIBINAGAR
- 40 MINS DRIVE
GHATKESAR ORR EXIT
- 50 MINS DRIVE
UPPAL METRO STATION

PROJECT HIGHLIGHTS:

- DTCP AND RER^o APPROVED LAYOUT (LP NO. 58/2022/H)
- AESTHETIC GREEN PARKS
- RAINWATER HARVESTING PITS
- CLEAR TITLE AND SPOT REGISTRATION
- 24 X 7 SECURITY WITH CCTV CAMERAS
- 40' & 33' FEET WIDE BT ROADS WITH MEDIAN & FOOTPATH
- MAJESTIC ENTRANCE ARCH
- COMPOUND WALL
- TAP CONNECTION FOR EACH PLOT
- UNDERGROUND SEWERAGE SYSTEM
- KIDS PLAY AREA
- BEAUTIFUL AVENUE PLANTATION
- ELECTRICITY WITH STREET LIGHTS
- OVERHEAD WATER TANK
- 100% VAASTU COMPLIANT PLOTS
- POLLUTION FREE ZONE

SVS INDRAPRASTHA

SPECIFICATIONS

STRUCTURE

RCC framework

SUPER STRUCTURE

External walls - 9" thick constructed with red brick

Internal walls - 4 1/2" thick constructed with red brick

Roof - Cement Based Tiles will be supplied and installed for the roof structure offering a robust and aesthetic solution.

WALL FINISHING

External- Plastering of 20mm thick in two coats, with base coat of 16mm thickness in CM (1:6) and top coat of 4mm thickness in CM (1:4) with dubara sponge finish as per IS:456-2000.

Internal -Plastering of 15mm thick in two coats, with base coat of 10mm thickness in CM (1:6) and top coat of 5mm thickness in CM (1:4) with dubara sponge finish as per IS:456- 2000.

DOORS

Doors to have teakwood frame with flush door shutters with veneer/laminate as per design with good quality hardware.

WINDOWS & VENTILATORS

UPVC Wooden Finish

FLOORING

Kota Stone - Natural Stone flooring of 20mm thick laid over cement motor 1:4. Finishing & joints with chemical grouting and matching colour.

KITCHEN

Granite platform with single bowl stainless steel sink.

TOILETS

Flooring, Wall Dado & Sanitaryware – WC, wash basin, mixer & overhead shower of Jaguar, Cera, Parryware or equivalent make.

PAINTING

Exterior

External to have cladding/Asian exterior paint as per elevation.

Interior

Internal walls to be finished with 2 coats putty and acrylic emulsion paint of Asian paints.

ELEVATION

Brick Jali pattern as per design.

ELECTRICAL

Concealed copper wiring of reputed make, modular switches of reputed make. Power outlet for ac's and electronic gadgets will be provided as per customized requirement.

LANDSCAPING

As per architect

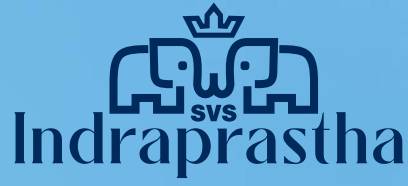

YADAGIRIGUTTA

Site Address: SY.No's.253/P,254/P & 255/P
Peddakandukur(V), Yadagirigutta(M),
Yadadri Bhuvanagiri District



SVS LIFESPACES PRIVATE LIMITED

H.NO. 12-44-63/1864, 2 Floor, Road No. 2, P&T Colony,
Opposite Kakatiya Hospital, Medipally, Medchal-
Malkajiri District, Hyderabad, Telangana - 500092.

+91 97 6969 4444, +91 97 6969 8888

sales@svsinfradevelopers.com | follow us on     

www.svsinfradevelopers.com



SCAN QR CODE
FOR LOCATION



L.P No. 58/2022/H



RERA NO.P02000004644

Bank loans
Available from



Disclaimer: The plans, specifications, images and other details herein are only indicative and the developer/owner reserve the right to change any or all. The printed material does not constitute a contract/offer of any type between the developer/owner and the re-cipient. Any purchase/lessee of this development shall be governed by the terms and conditions of the agreement for sale/lease entered into between parties and no details mentioned in this printed material shall in any way govern such transaction.