

# Semi Deluxe 2 Bhk Project

Here is a Semi Deluxe Stand Alone Project by USA based NRI Construction company in HYDERABAD. @ Koremulla, Jodimetla very near to Pocharam & Ghatkesar, (Infosys & Genpact) Hyderabad. Just 700 Mts form the Hyderabad-Warangal Highway.

Adress of the Project :

Plot Nos: 3 Srinidhi Enclave, Korremula Village,  
Jodimetla-500088 Medchal-Malkajgiri Dist.  
TELANGANA-INDIA.

Google Location:

<https://goo.gl/maps/hwrqq9MsxvPdQACy7>

Contact Details:

Manasri Infrastructure & Developers Pvt Ltd. #  
401,4th Floor,H.No. 8-2-611/3, Nishaa-na  
Iqbal, Gaffar Khan Colony Road No.11,  
Banjara Hills, Hyderabad-500034.  
India:+914048589234

US Off: 116 Village Blvd, Suite-200, Princeton NJ-  
08540 Ct: +1 (609) 534 5467 (Ananth)



## Semi Deluxe Flats 1005 Sft East & West 2 Bhk

### Location:

- 2 Min drive 10 Min walk from Warangal High Way-0.7 km
- 10 Minutes drive from Pocharam Infosys-3 km
- 10 Min drive from Uppal Depot 20 Min from Uppal X Roads
- 30 Minutes drive from Habsiguda
- 09 Mins Drive to ORR 6 Km
- 50 Mins Drive to Airport 49 Kms.

### Silent Features:

- 20 flats 2 Blocks, Each Block 10 flats
- Stilt + 5 floors
- Stilt floor with Landscape
- 2 BHK flats 1005
- Plan approved by HMDA
- Clear title HMDA Layout
- RERA Registered
- All flats designed as per Vaastu
- No commercial activities within site
- CC Tv Surveillance
- Solar Fencing
- Power Backup for common areas & 1 Kv to Each Flat.

Site: P.No:3 & 4, Korremula, (Jodimetla) Chowdarguda,  
 Sy Nos: 773/^A/1, 773/^A/2, SRO Narapally,  
 Medchal-Malkajgiri Hyd-500088

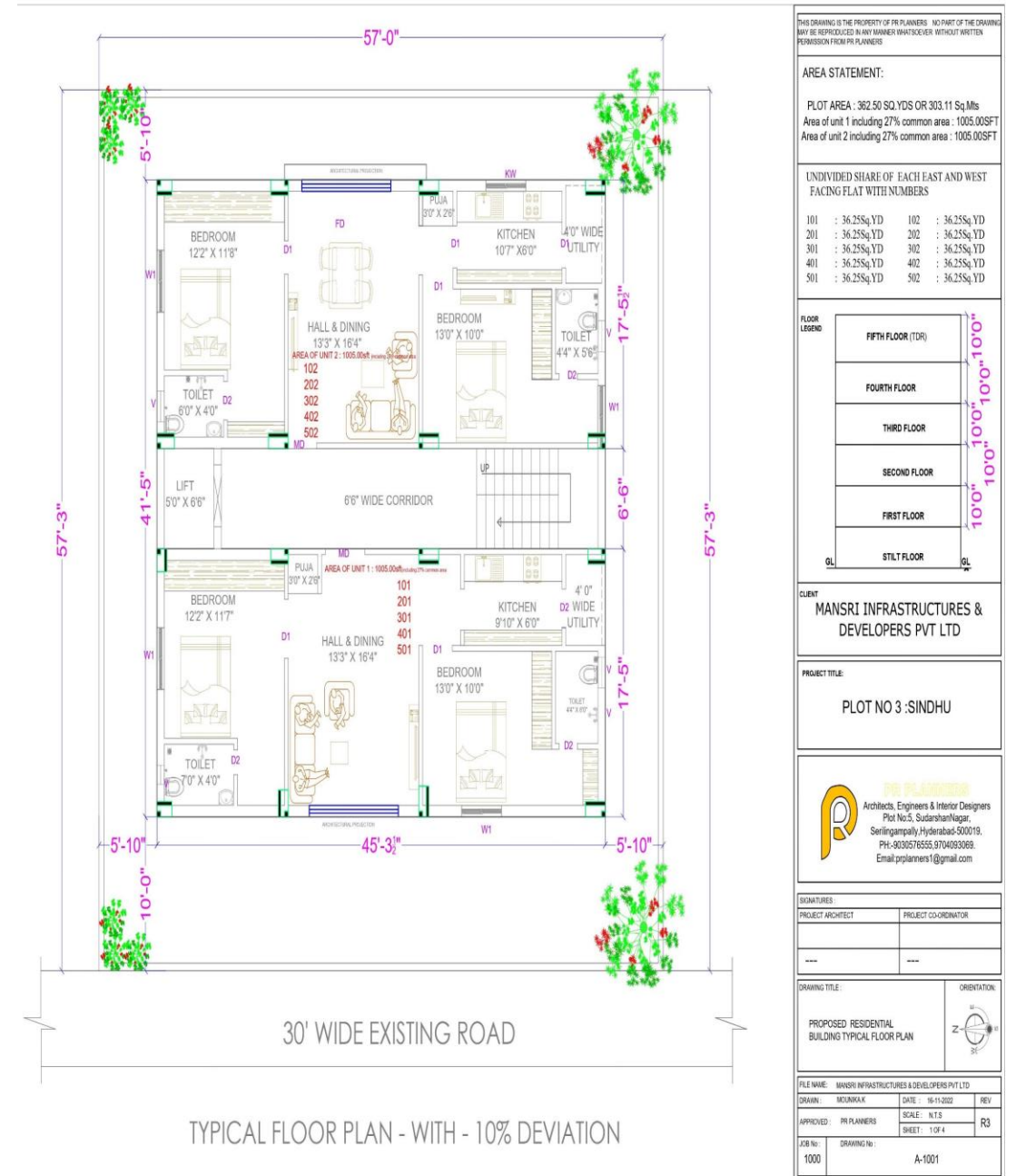

# Semi Deluxe 2 Bhk Project

Here is a Semi Deluxe Stand Alone Project by USA based NRI Construction company in HYDERABAD. @ Koremulla, Jodimetla very near to Pocharam & Ghatkesar, (Infosys & Genpact) Hyderabad. Just 700 Mts form the Hyderabad-Warangal Highway.

Adress of the Project :

Plot Nos: 4 Srinidhi Enclave, Korremula Village,  
Jodimetla-500088 Medchal-Malkajgiri Dist.  
TELANGANA-INDIA.

Google Location:

<https://goo.gl/maps/hwrqq9MsxvPdQACy7>

Contact Details:

Manasri Infrastructure & Developers Pvt Ltd. #  
401,4th Floor,H.No. 8-2-611/3, Nishaa-na  
Iqbal, Gaffar Khan Colony Road No.11, Banjara  
Hills, Hyderabad-500034. India:+914048589234

US Off: 116 Village Blvd, Suite-200, Princeton NJ-08540  
Ct: +1 (609) 534 5467 (Ananth)



## Semi Deluxe Flats 1119 Sft North 1353 Sft East 2 Bhk

### Location:

- 2 Min drive 10 Min walk from Warangal High Way-0.7 km
- 10 Minutes drive from Pocharam Infosys-3 km
- 10 Min drive from Uppal Depot 20 Min from Uppal X Roads
- 30 Minutes drive from Habsiguda
- 09 Mins Drive to ORR 6 Km
- 50 Mins Drive to Airport 49 Kms.

### Silent Features:

- 20 flats 2 Blocks, Each Block 10 flats
- Stilt + 5 floors
- Stilt floor with Landscape
- 2 BHK flats 1119 North 1353 East
- Plan approved by HMDA
- Clear title HMDA Layout
- RERA Registered
- All flats designed as per Vaastu
- No commercial activities within site
- CC Tv Surveillance
- Solar Fencing
- Power Backup for common areas & 1 Kv to Each Flat.

Site: P.No:3 & 4, Korremula, (Jodimetla) Chowdarguda,  
 Sy Nos: 773/^A/1, 773/^A/2, SRO Narapally,  
 Medchal-Malkajgiri Hyd-500088

